

HELGOLAND ADJ SMD - CLASS III

design
Carlotta de Bevilacqua

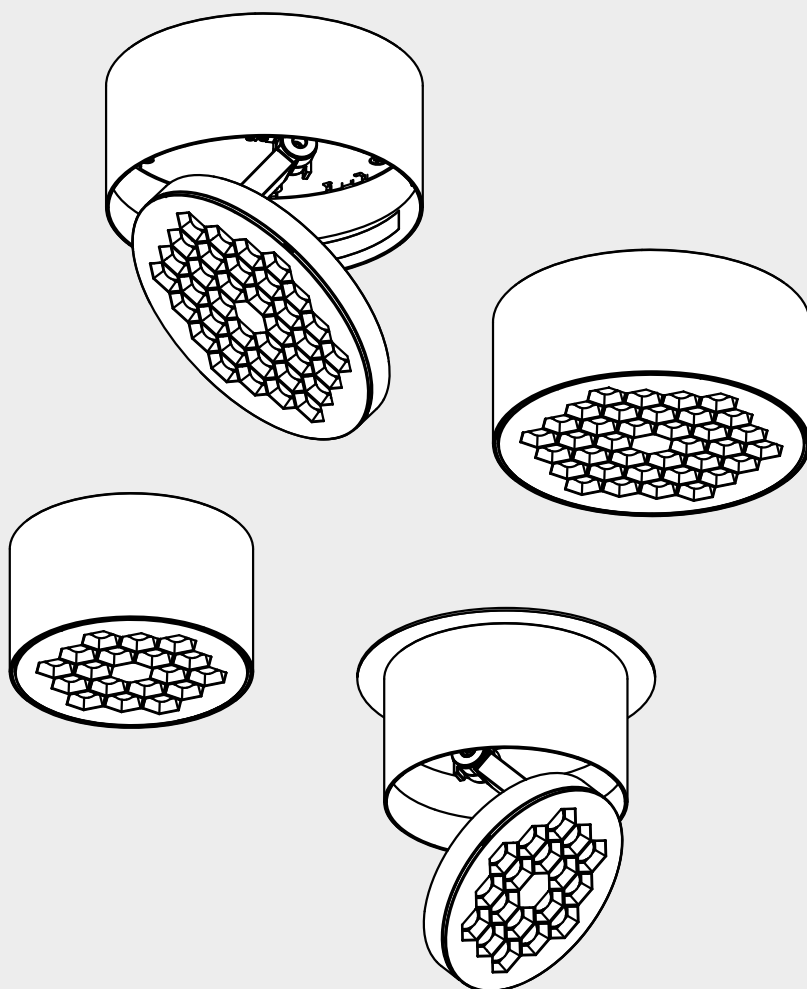



i

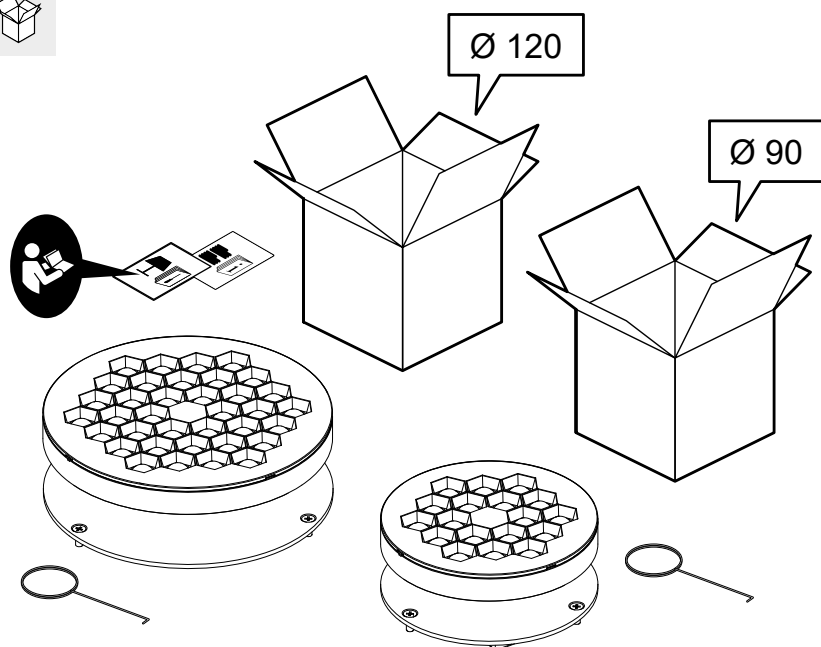
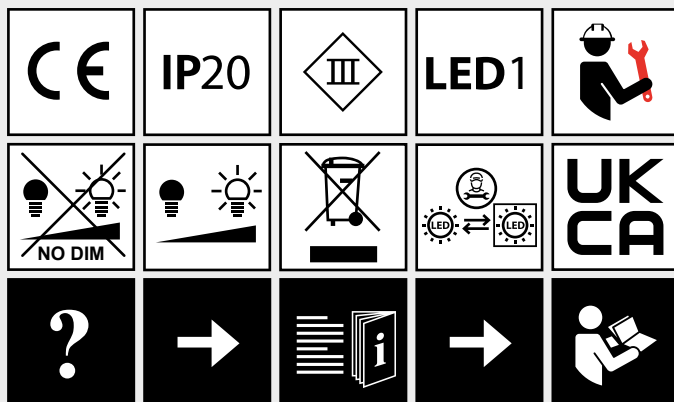



Ø 120

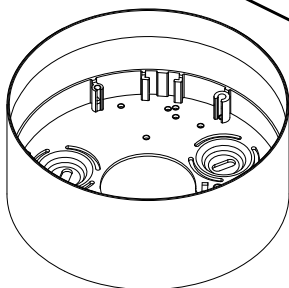
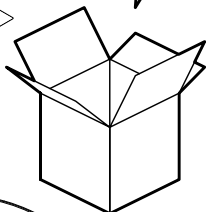

Ø 90

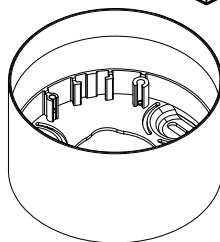
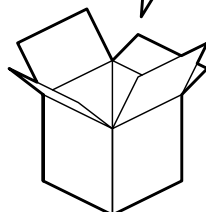

US / CANADA ONLY

AX90000

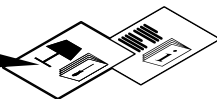
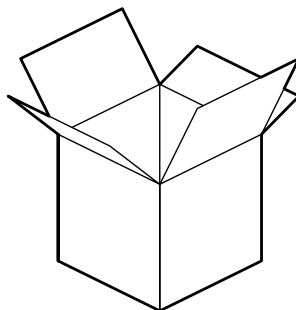
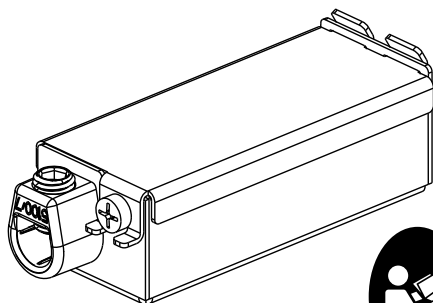



US / CANADA ONLY

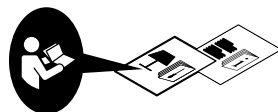

AX90200

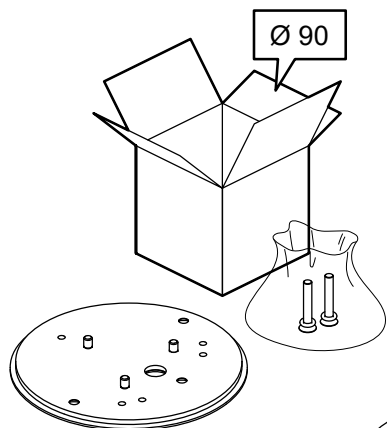

AX90300

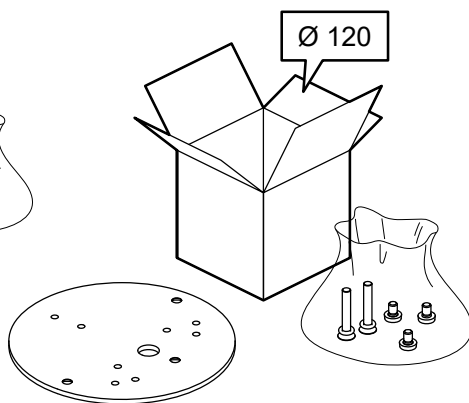

EU / WORLDWIDE

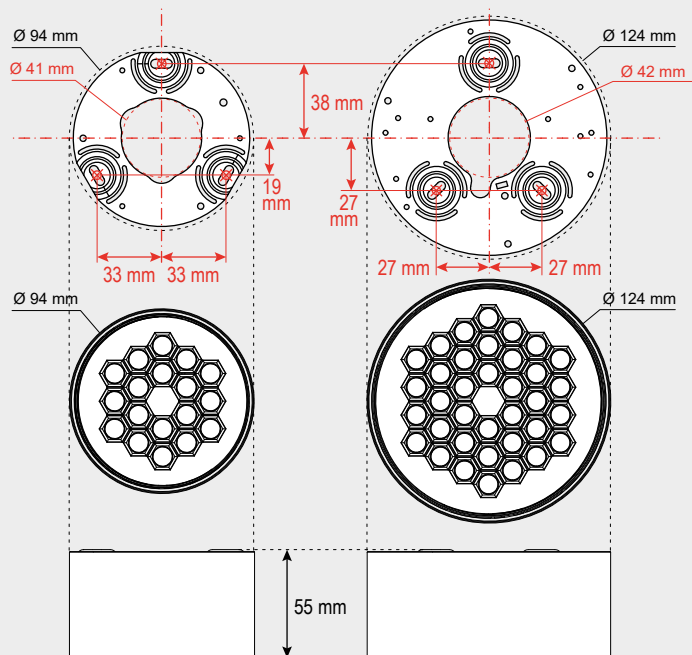
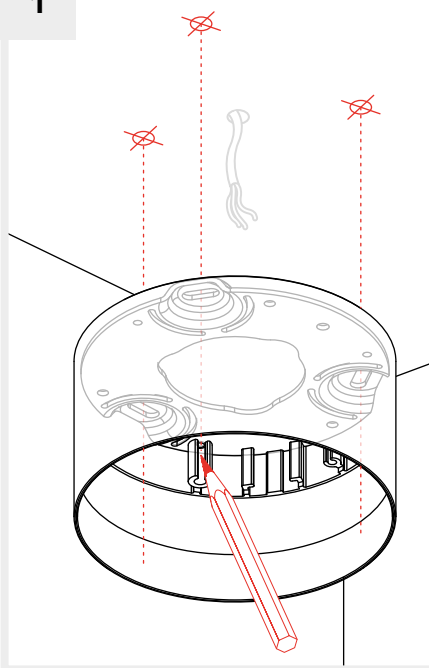
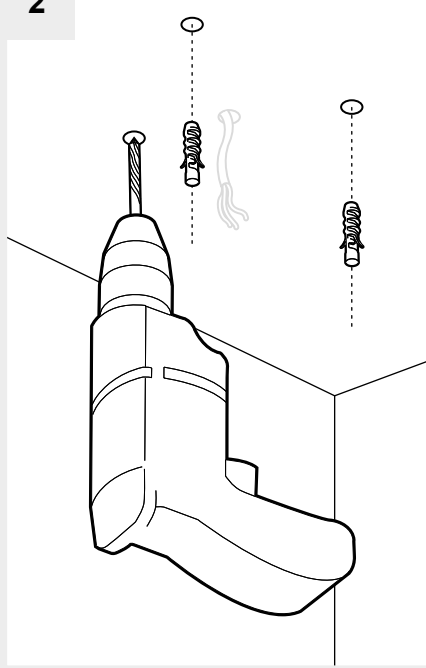
i**1****2**

3

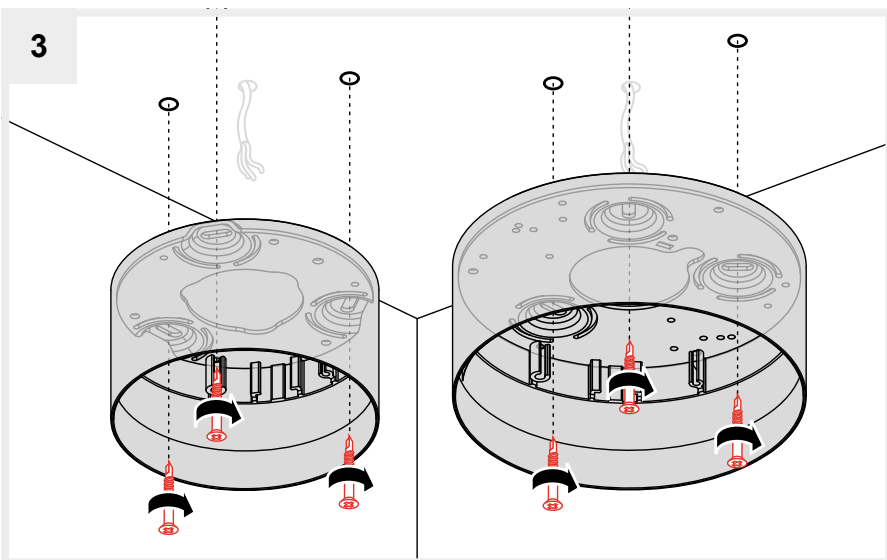

4a

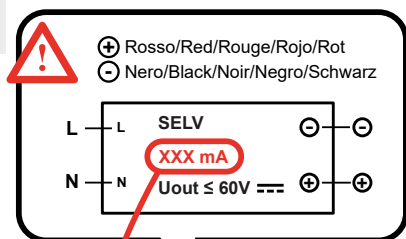

L_{max} [m]	10	20	50
\varnothing_{max} [mm ²]	0,50	1,00	2,50

$L_{max} - \varnothing_{max}$

11 mm

3°

2°

1°

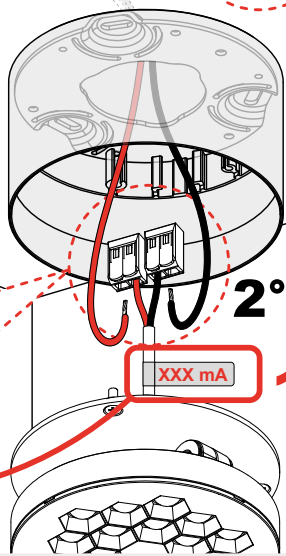
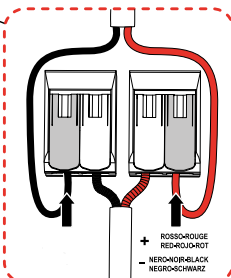
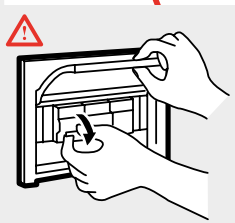

4b

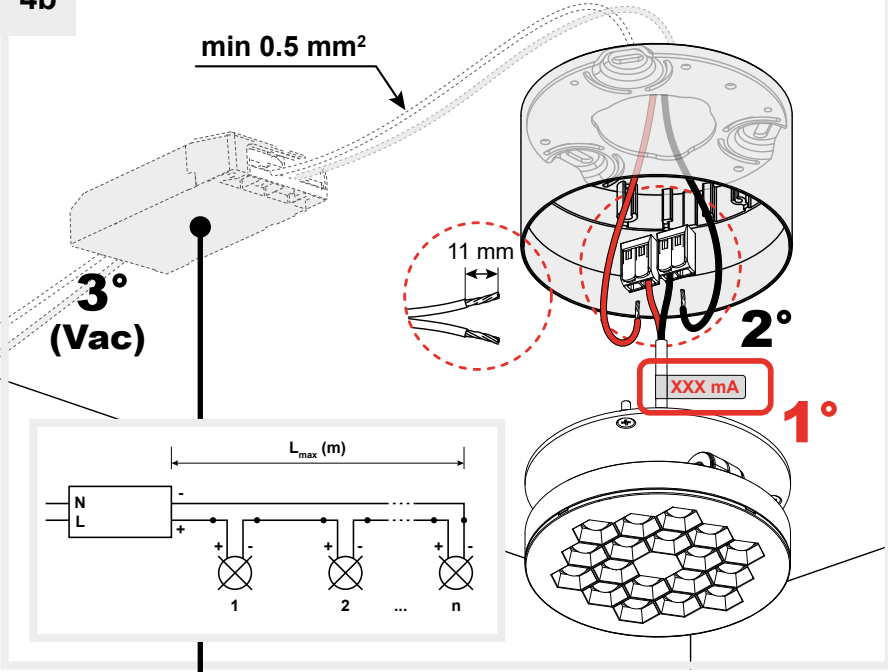

Helgoland sizes [Ø mm]	Remote driver type	Code	Driver dimensions			Circuit breaker	Max distance [m]	Current setting [mA]	V module	Devices nr.
			L [mm]	W [mm]	H [mm]					
90	ND	DV1037	146.5	42.5	22	A 16-30 B 16-50 C 16-70	20	350	17V	1 min 2 max
	DALI2 / 0-10 / PUSH	DV1126	111	52	22	A 16-30 B 16-50 C 16-70	15			1 min 2 max
	APP & PUSH	DV1129APP	146.5	44	30	D 16-100	15			1 min 2 max
120	ND	DV1037	146.5	42.5	22	A 16-30 B 16-50 C 16-70	20	500	17V	1 min 2 max
	DALI2 / 0-10 / PUSH	DV1126	111	52	22	A 16-30 B 16-50 C 16-70 D 16-100	15			1 min 2 max
	APP & PUSH	DV1104APP	124	79	22	A 16-20 B 16-30 C 16-50	15			1 min 2 max

5

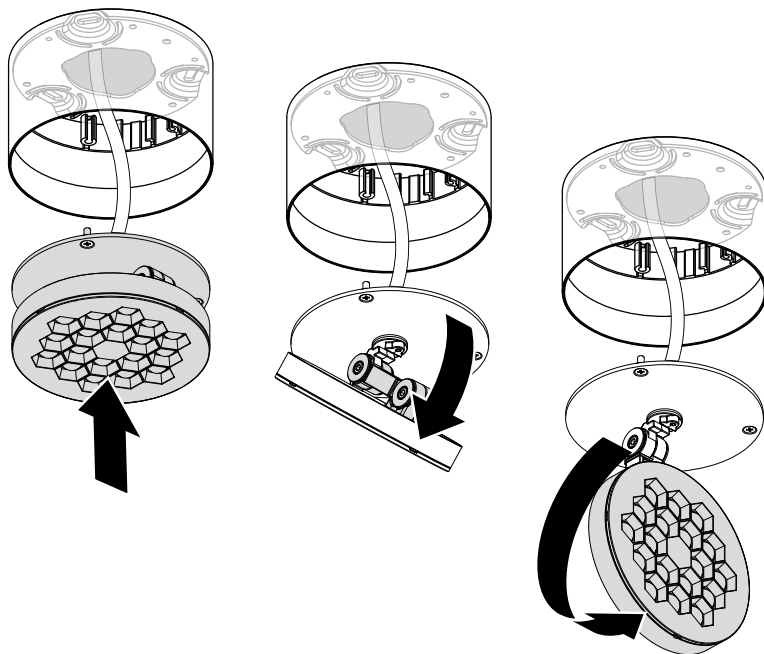

6

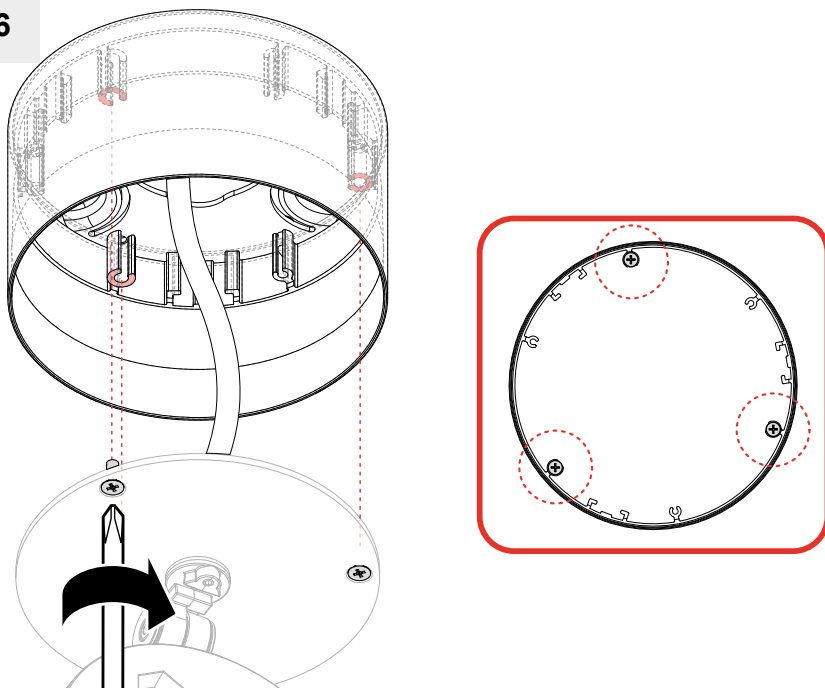

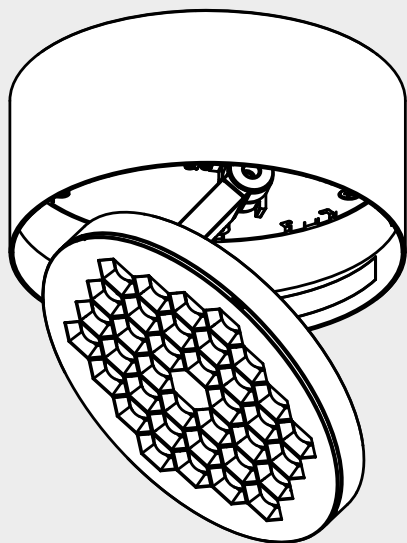

US / CANADA ONLY

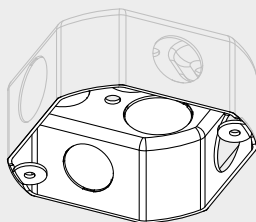

i

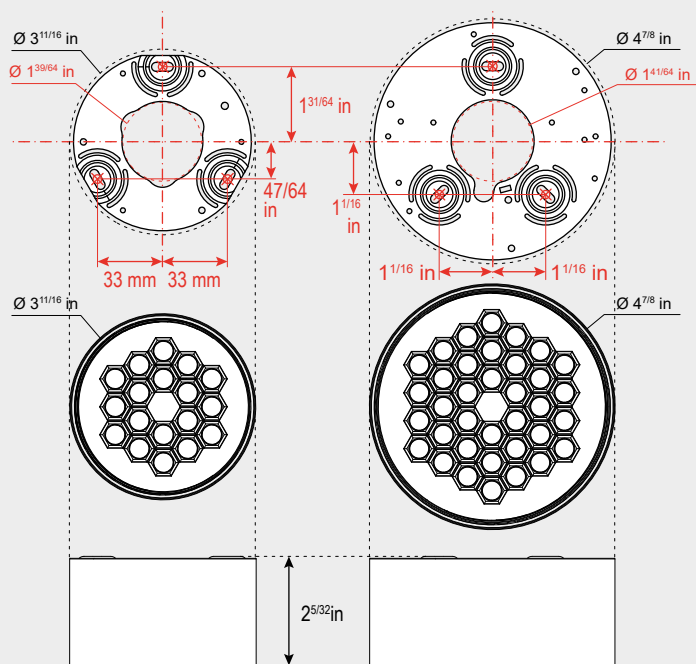

1

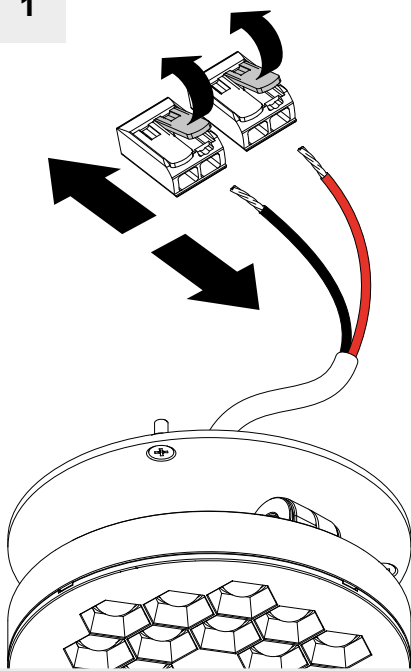

ONLY FOR $\varnothing 90$

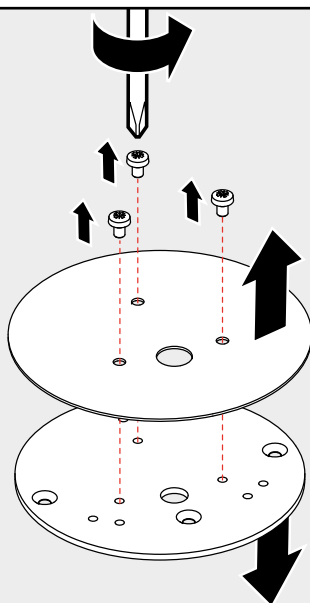

2

Use only CMG cable
Utilisez uniquement CMG câble
Utilice únicamente el cable CMG

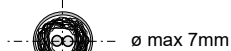

Use only with class 2 power unit
Utiliser exclusivement avec class 2 alimentation
Utilícese únicamente con unidad de alimentación de clase 2

red/rouge/rojo +
black/noir/negro - CLASS 2



⊕ Rosso/Red/Rouge/Rojo/Rot
⊖ Nero/Black/Noir/Negro/Schwarz

3°

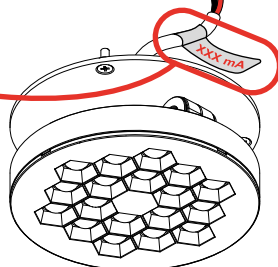
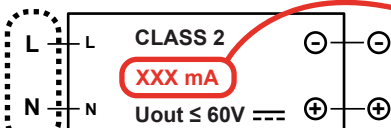

3

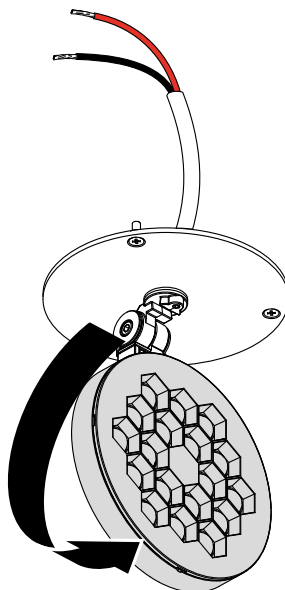
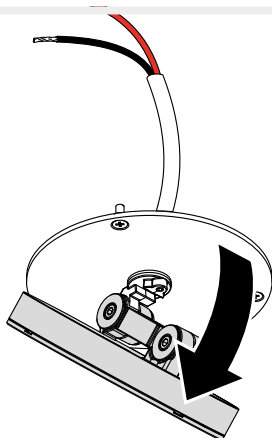
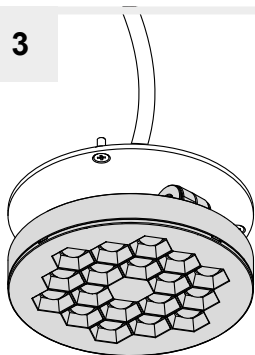

4

Ø 90

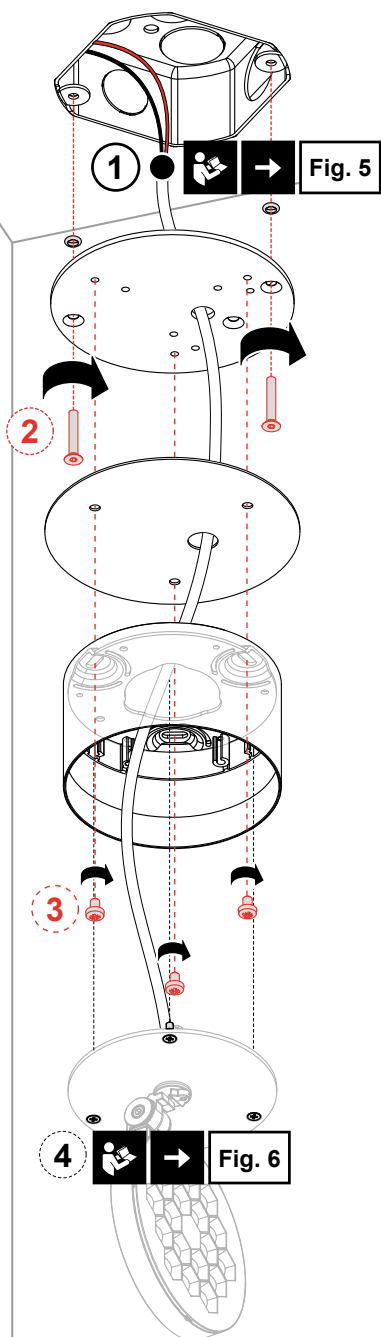

Ø 120

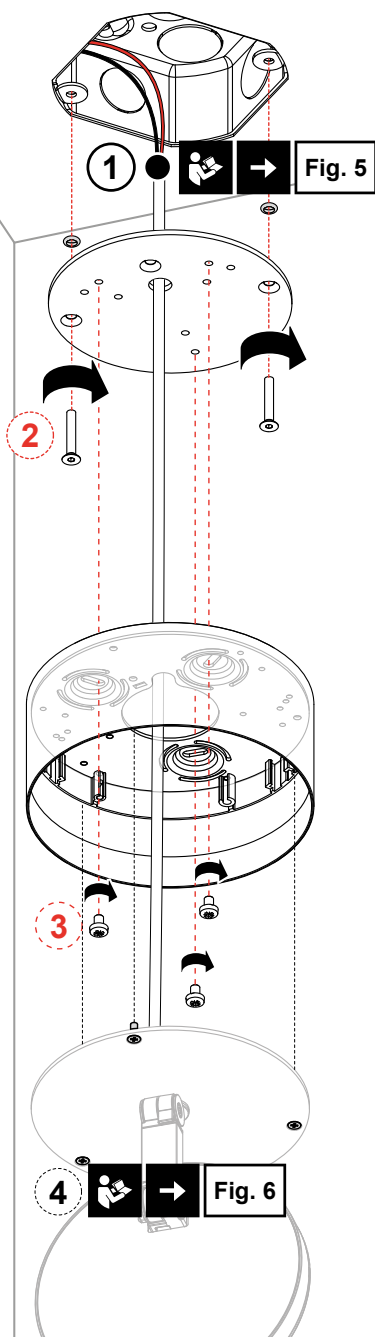

5

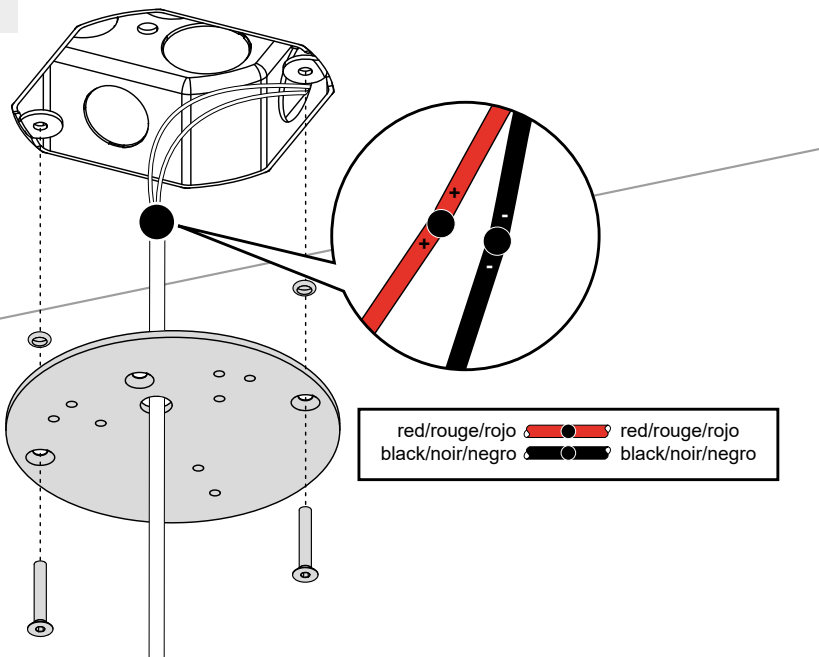

6

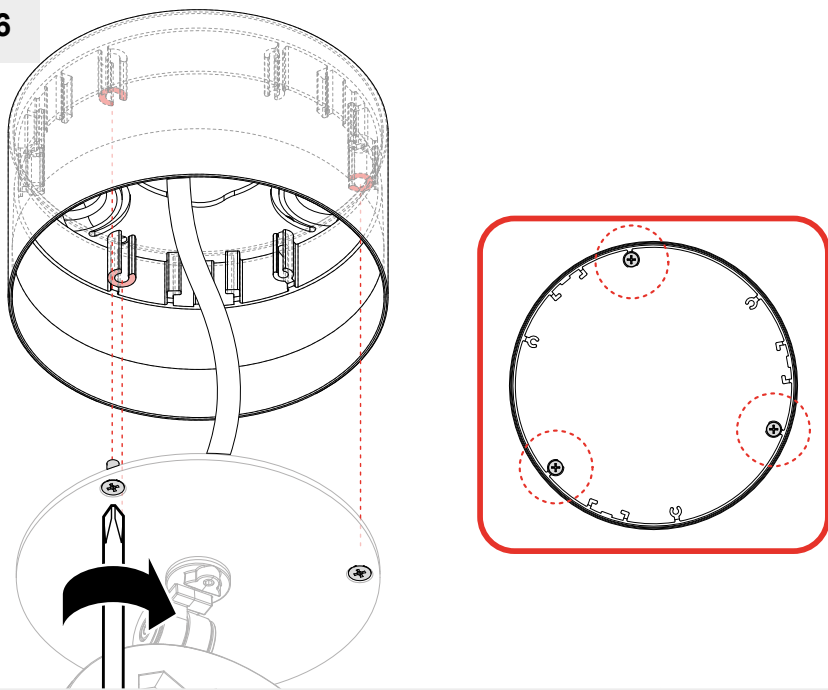

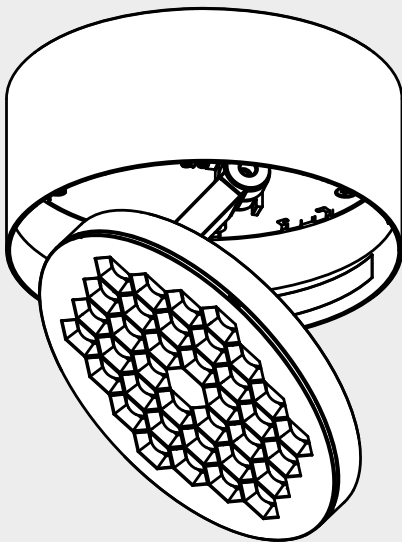

US / CANADA ONLY

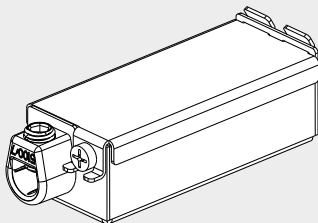

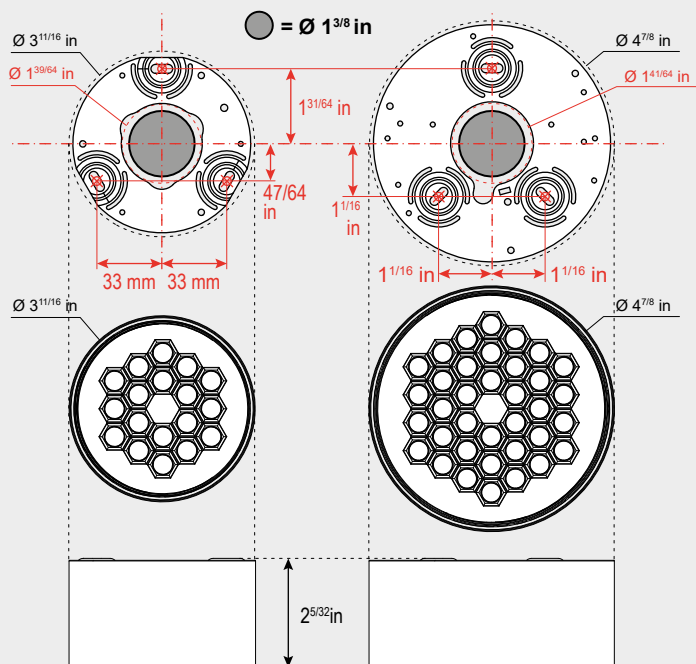
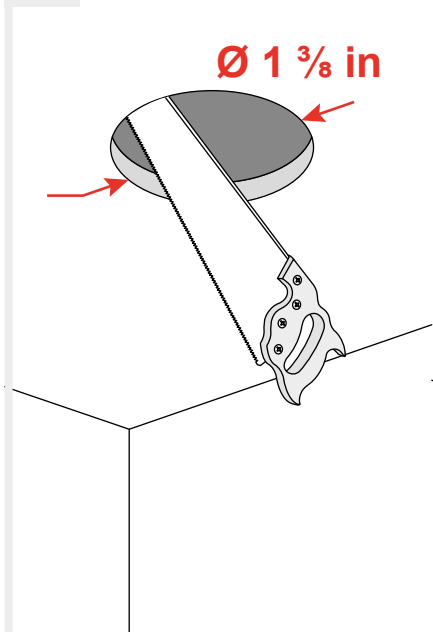
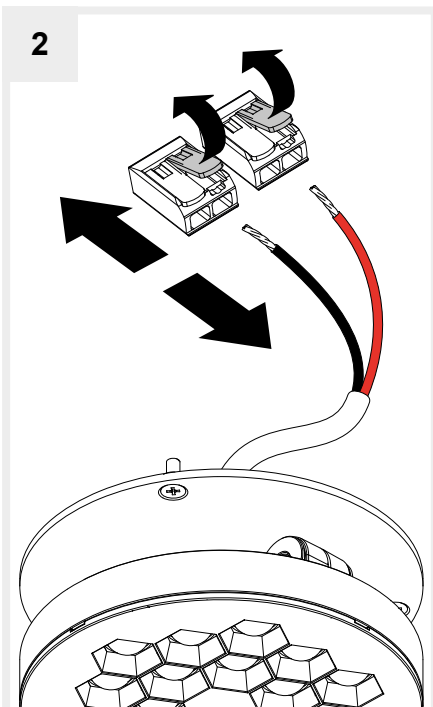
i**1****2**

3

Use only CMG cable
Utilisez uniquement CMG câble
Utilice únicamente el cable CMG

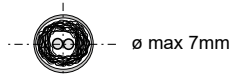

Use only with class 2 power unit
Utiliser exclusivement avec class 2 alimentation
Utilícese únicamente con unidad de alimentación de clase 2

red/rouge/rojo + CLASS 2
black/noir/negro -



⊕ Rosso/Red/Rouge/Rojo/Rot
⊖ Nero/Black/Noir/Negro/Schwarz

3°

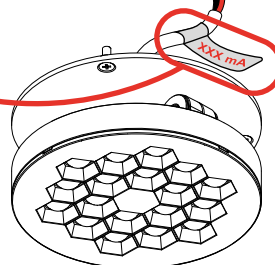

4

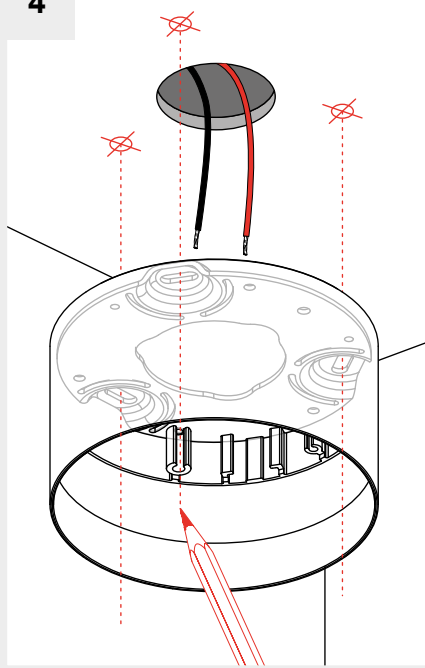

5

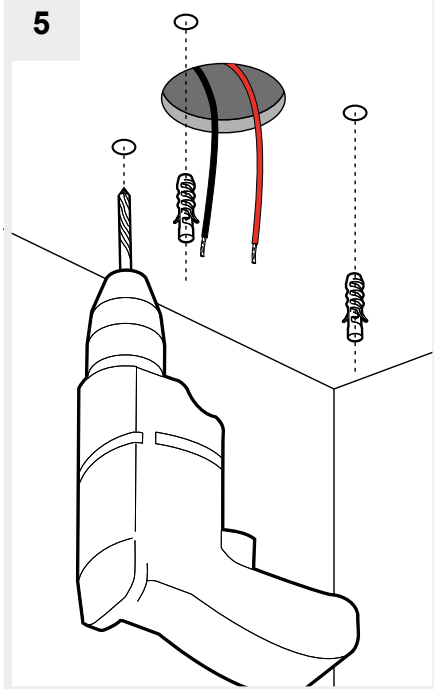

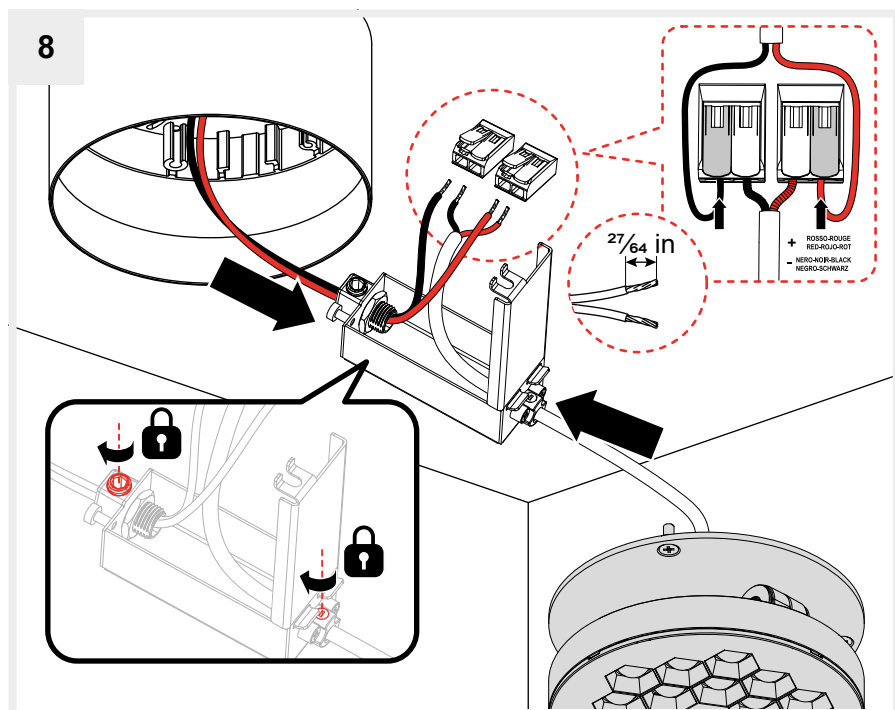
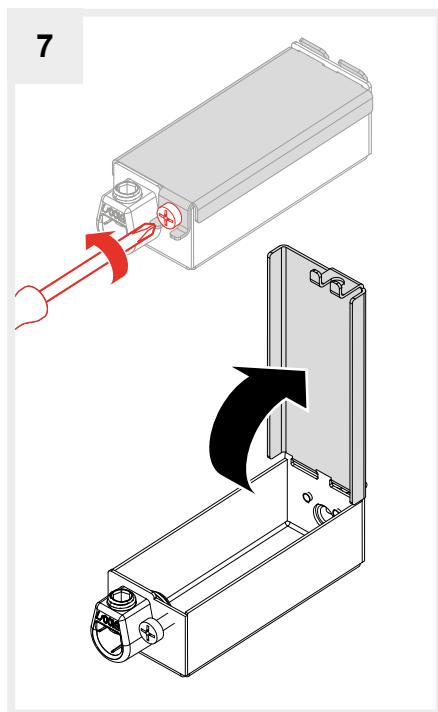
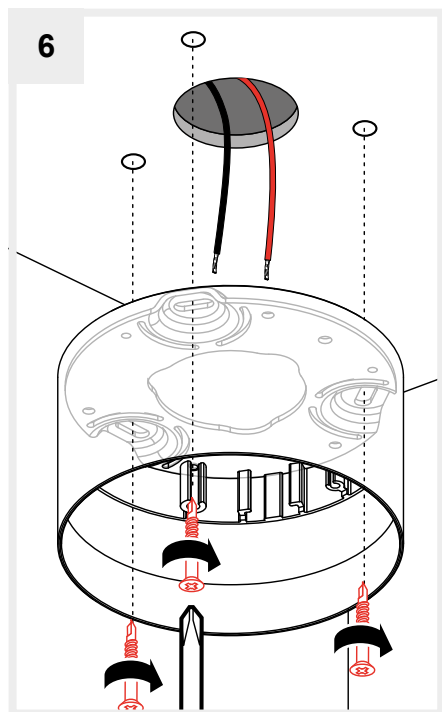

9

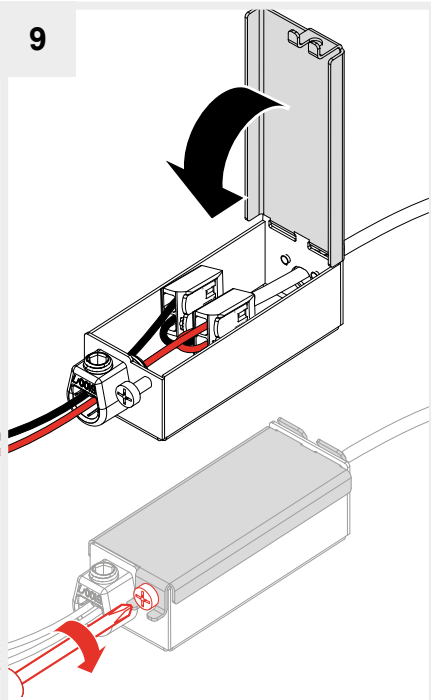

10

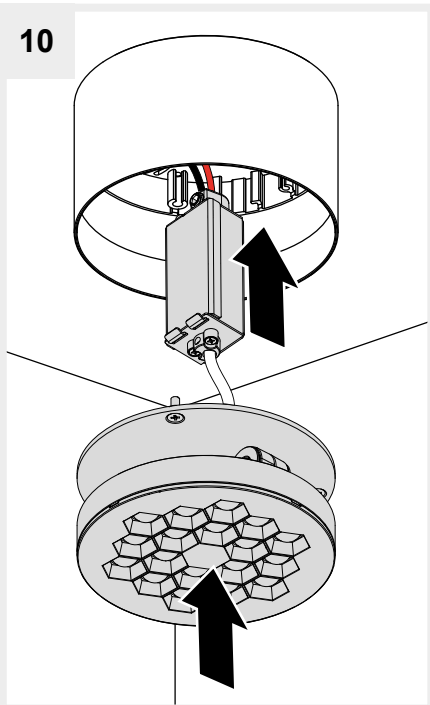

11

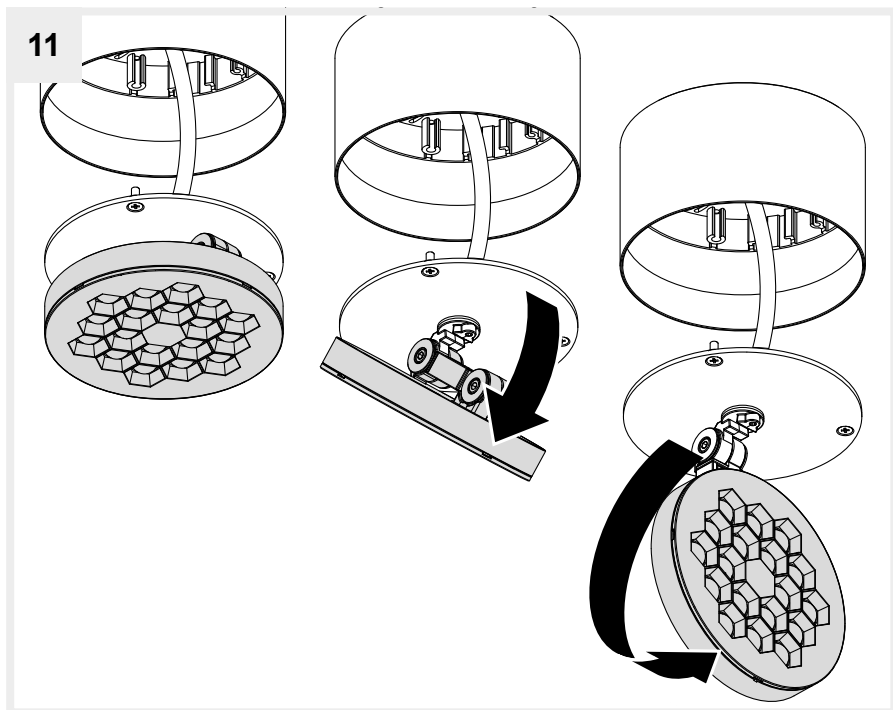

12

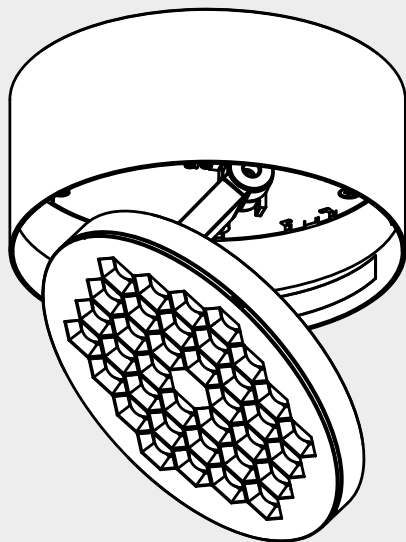
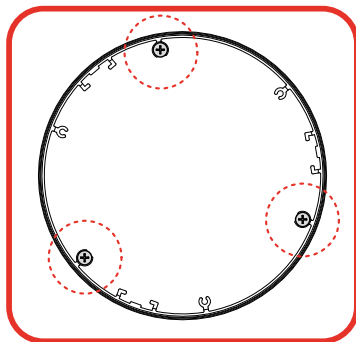
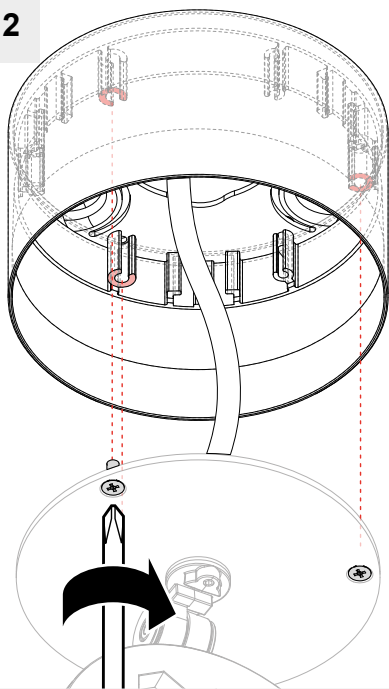



MAX 90°

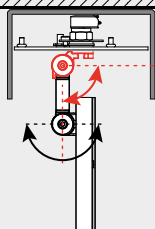
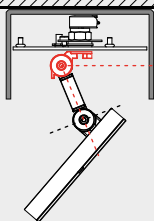
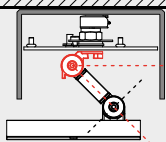
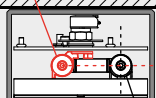

MAX 180°

360°

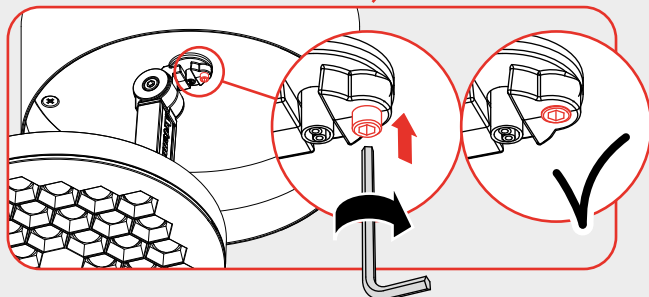
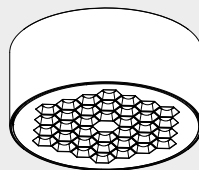
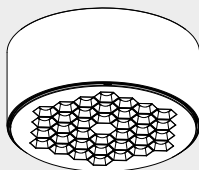
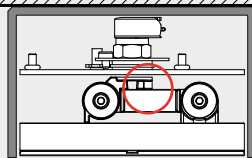
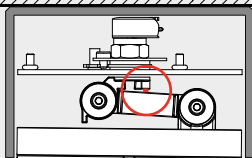
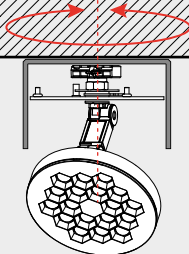

18

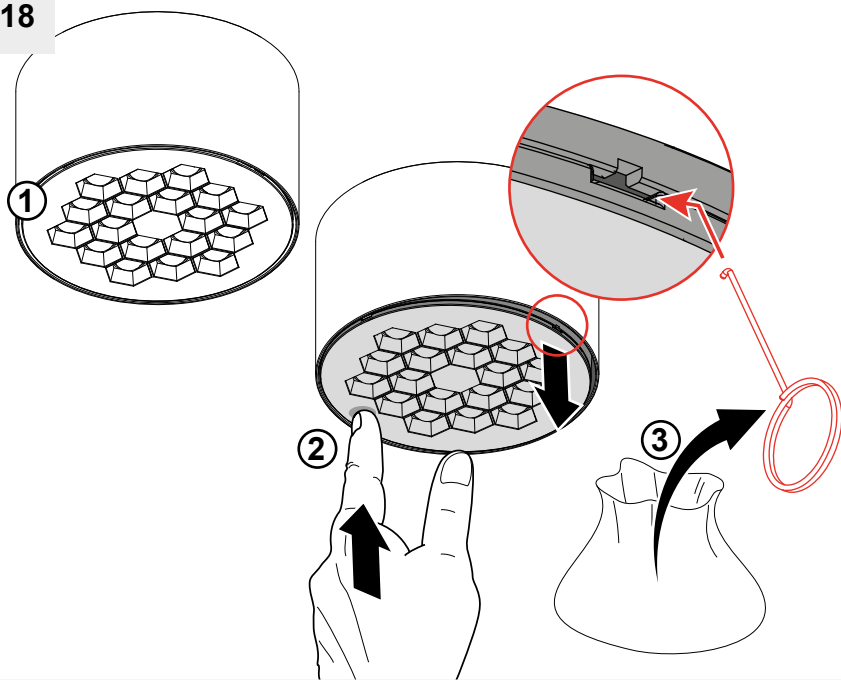

19

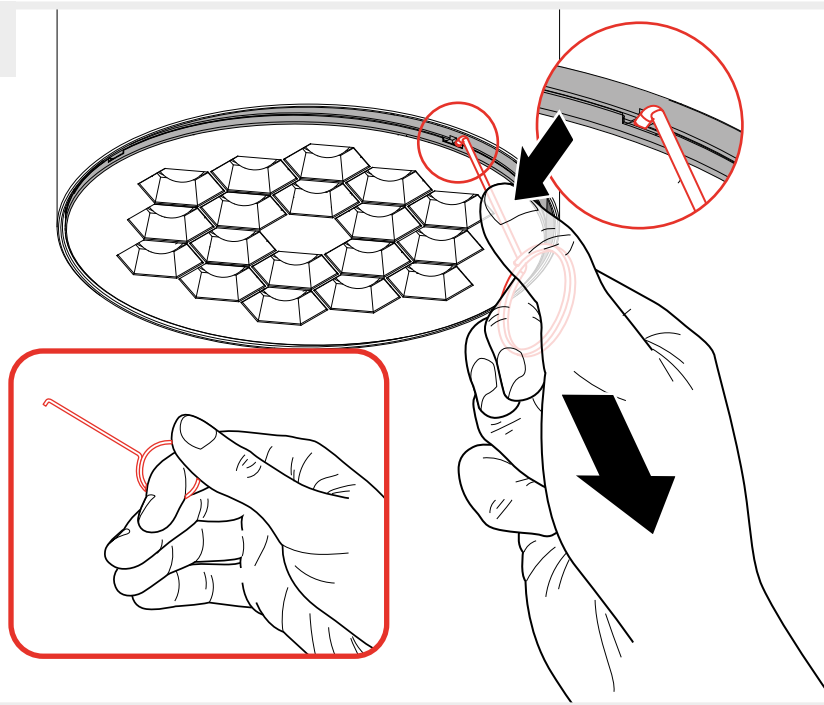

20

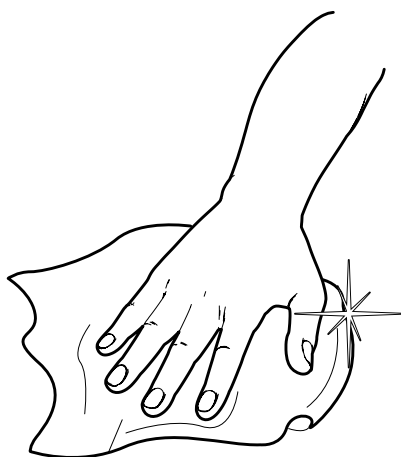
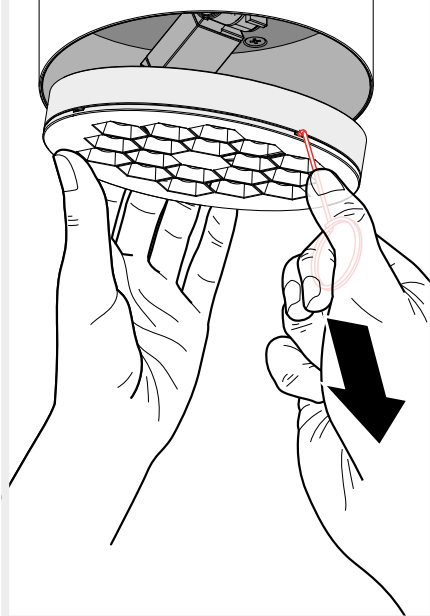

Artemide®



Artemide

via Bergamo, 18
20006 Pregnana M.se (MI)
ITALIA

tel. +39 02 935 181
fax +39 02 935 90 254
fax +39 02 935 90 496

www.artemide.com

VAT IT00846890150

Artemide Inc.

250 Karin Lane
Hicksville, NY 11801

tel. 631 694 9292
Toll Free 1-877-Art-9111
Fax 631 694 9275

www.artemide.net

cod. Y513002230